

Movenpick Hotel Geneva 4 STAR

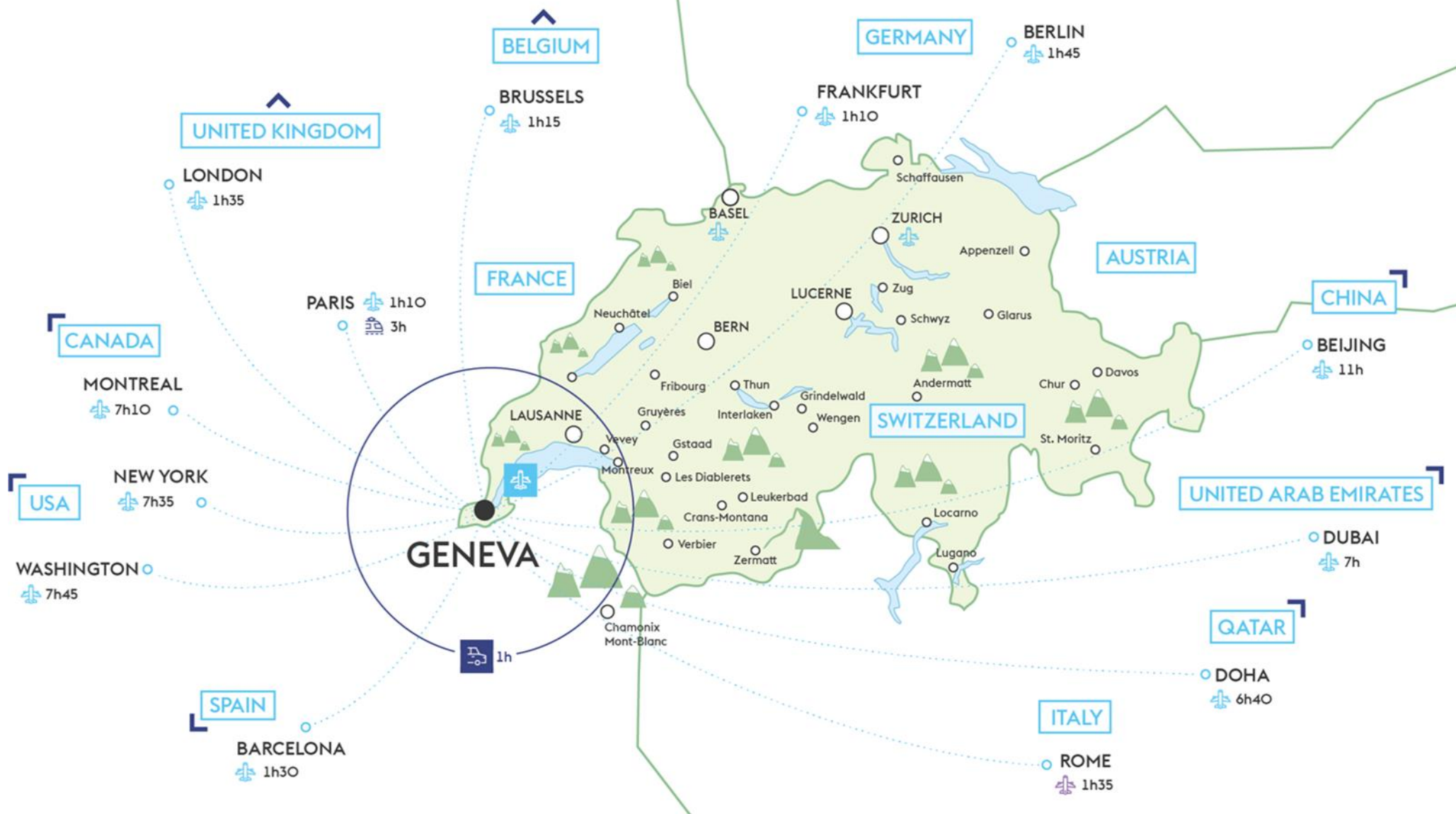

- Welcome to downtown Europe



Free **shuttle** from/to the Airport

50m from bus station

300m from tram station

15 min away from the city centre

Free **Geneva public transportation**
card during the stay

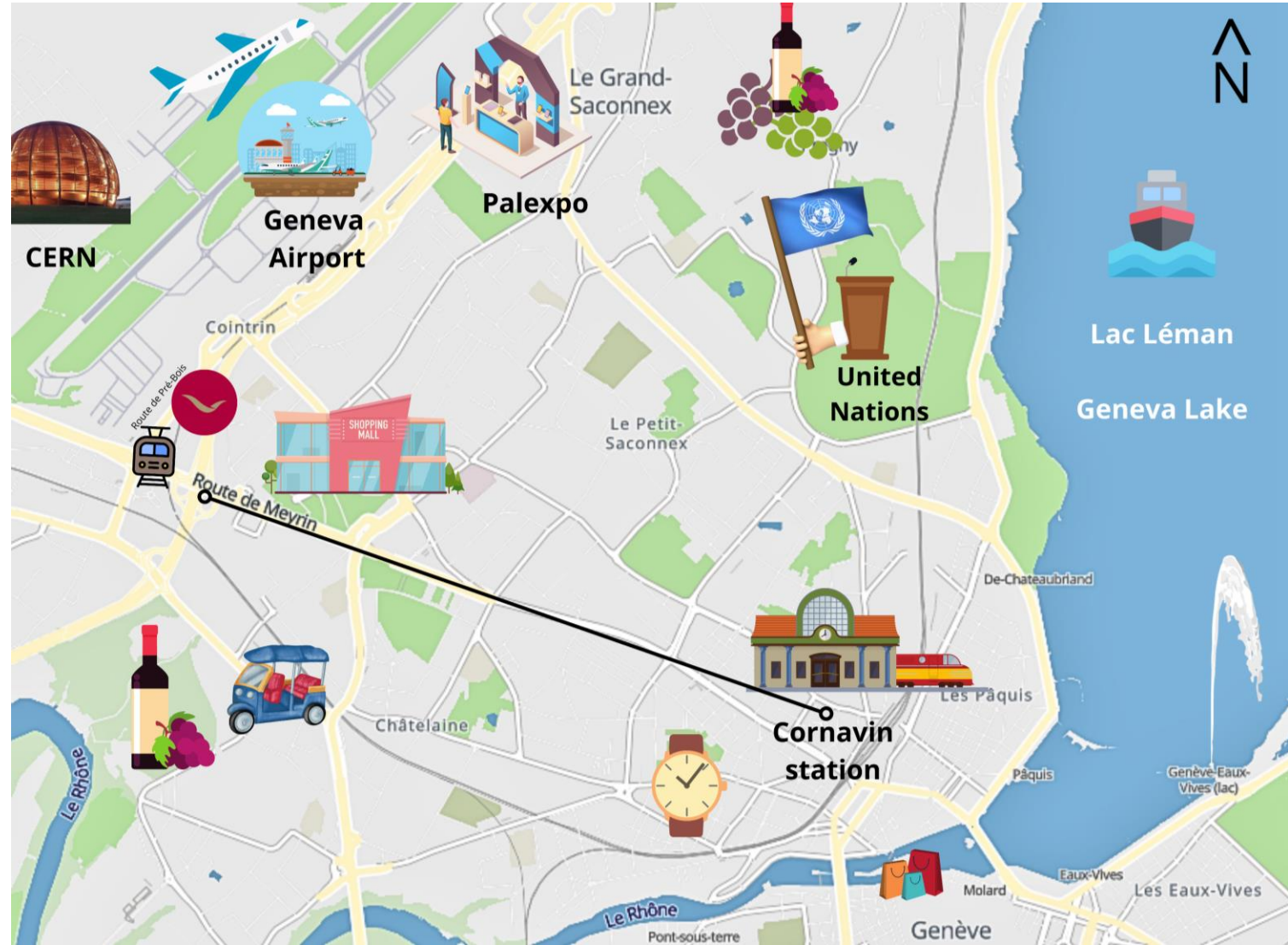



VISIT THE UN HEADQUARTERS



**KAYAK IN THE MIDDLE
OF THE CITY**



**TUKTUK TOUR IN THE
COUNTRYSIDE**



**VISIT THE RED CROSS
MUSEUM**



CHAMONIX MONT-BLANC
1H FROM GENEVA



CHILLON CASTLE
1H10 FROM GENEVA

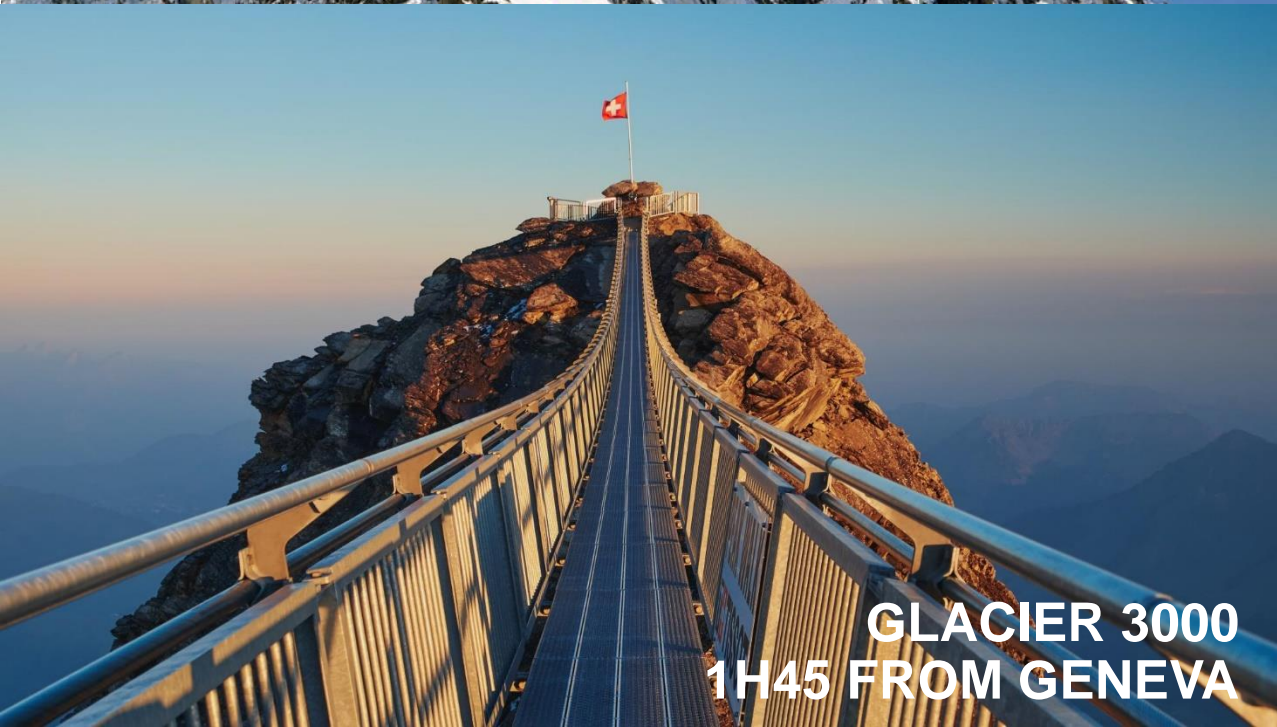

GLACIER 3000
1H45 FROM GENEVA



GRUYÈRES
1H30 FROM GENEVA

DELUXE TWIN ROOM



350 rooms

84 Twin rooms // 7 suites

36 connecting // 3 Handicap

- Air conditioning
- Tea and coffee facilities
- Free wi-fi
- 22 sqm 1st category

CLASSIC ROOM



FAMILY ROOM



SKY SUITE



SWISS SUITE



SKY SUITE



JUNIOR SUITE





BREAKFAST & BAR

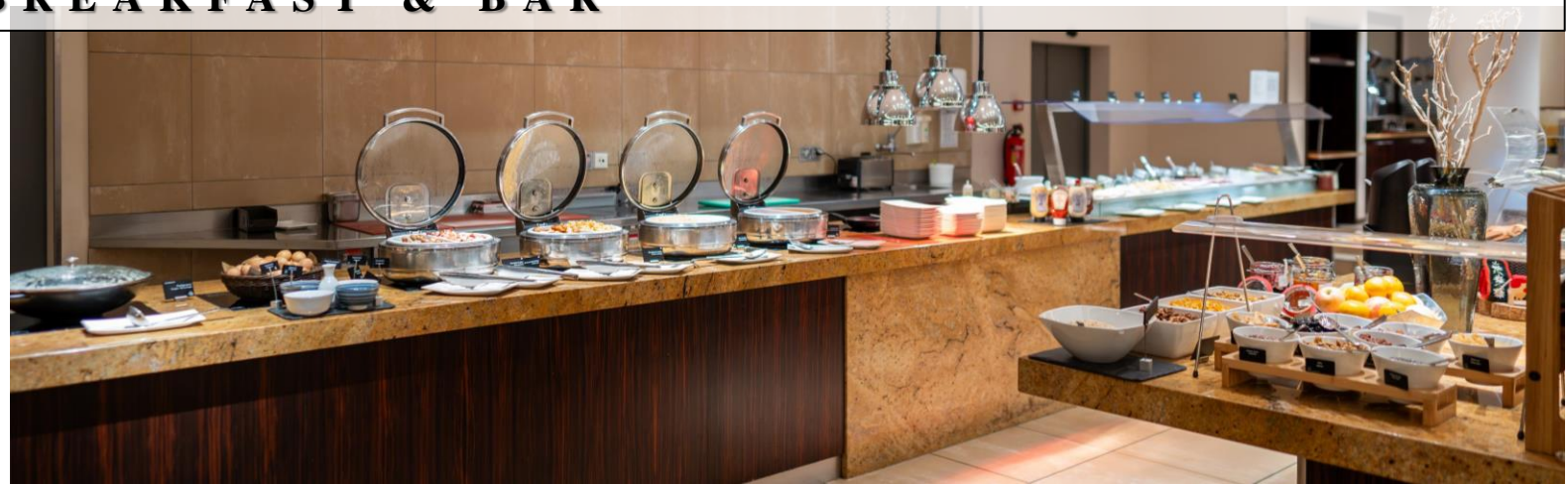

MÖVENPICK
HOTEL GENEVA



MÖVENPICK RESTAURANT - 120 persons seated



KAMOME RESTAURANT - 45 persons seated







4 STAR HOTEL

Movenpick Hotel Lausanne



EASY ACCESS





LAVAUx UNESCO



LAUSANNE BUSINESS VALLEY

Centre for Education, Research and Innovation



BELLE-ÉPOQUE BOAT



CASTLE CHILLON.



OLYMPIC MUSEUM



VINEYARDS



- Close to public transport: Trains, Metro and Bus
- 1hour from Geneva International Airport
- 50 m from bus station
- 500 m from metro station
- 10 min away from the city centre
- Free Lausanne public transportation card
- Garage (limited parking), public parking 50 m



DELUXE ROOM



SUPERIOR ROOM



337 rooms / 6 categories

- 23 SQM 1st category
- Double bed or twin beds
- Coffee machine
- Garden view with balcony in Premium rooms
- Lake view in Deluxe rooms

PREMIUM ROOM



DUPLEX SUITE



JUNIOR SUITE



JUNIOR SUITE



Seminars & conferences





NEW SPACE - CIAO





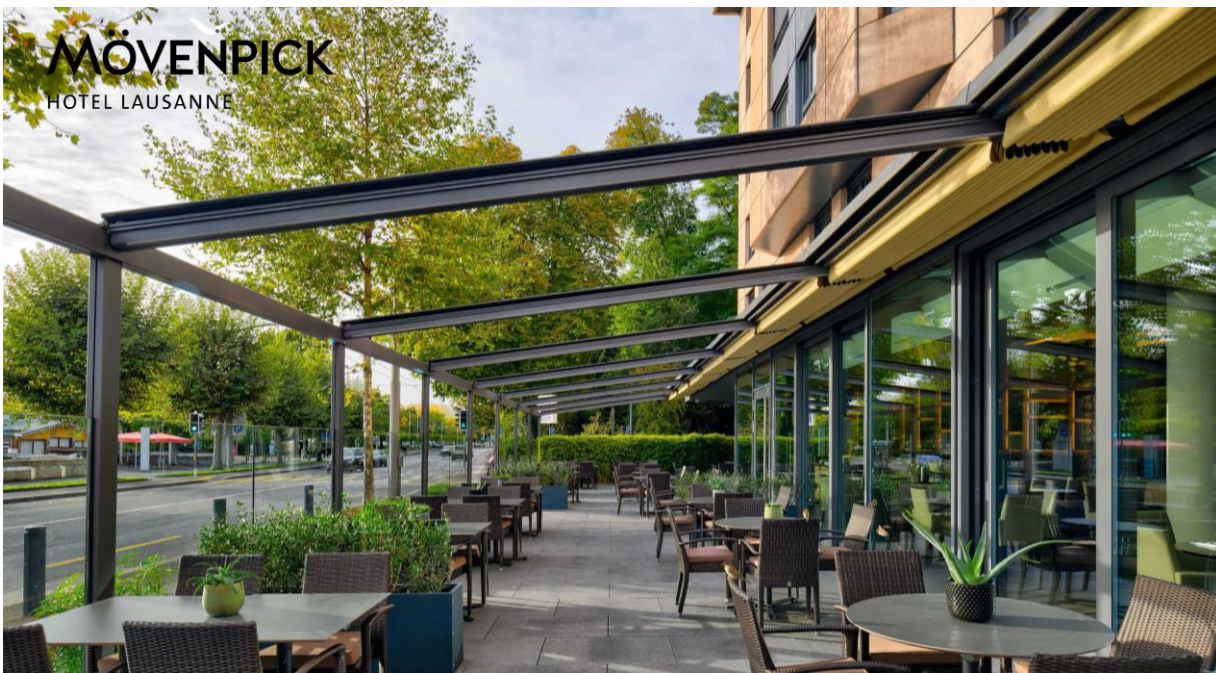

Mövenpick BAR



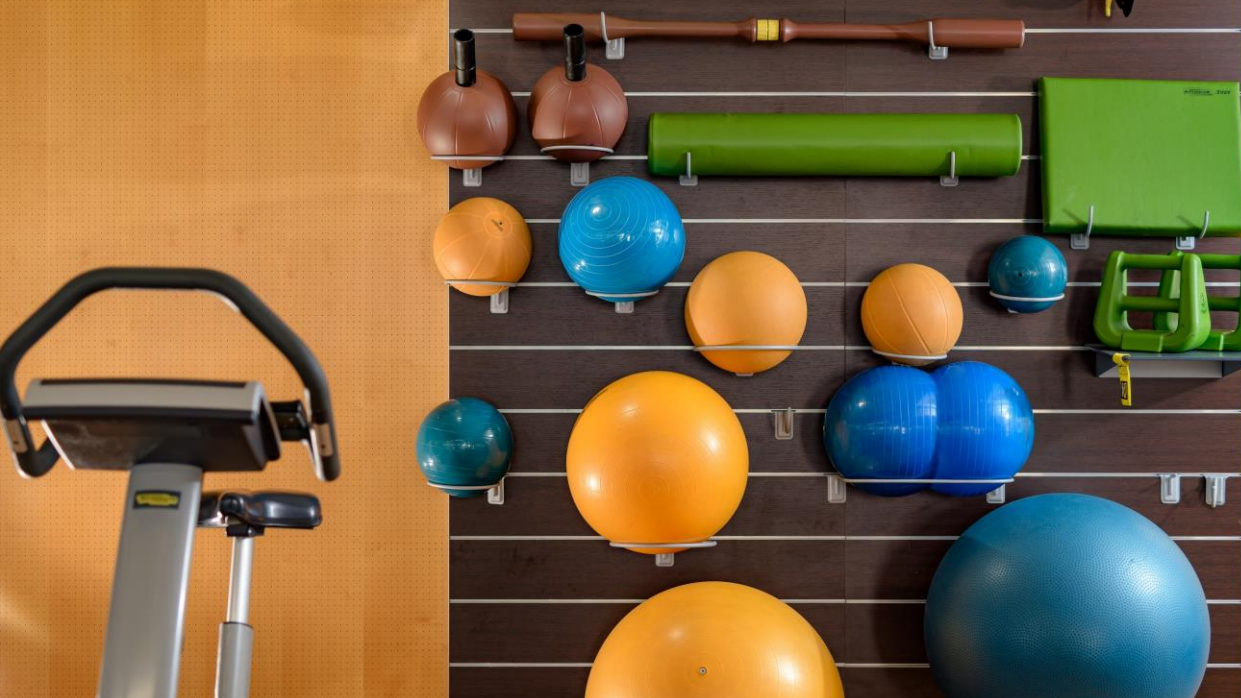

WELLNESS AREA

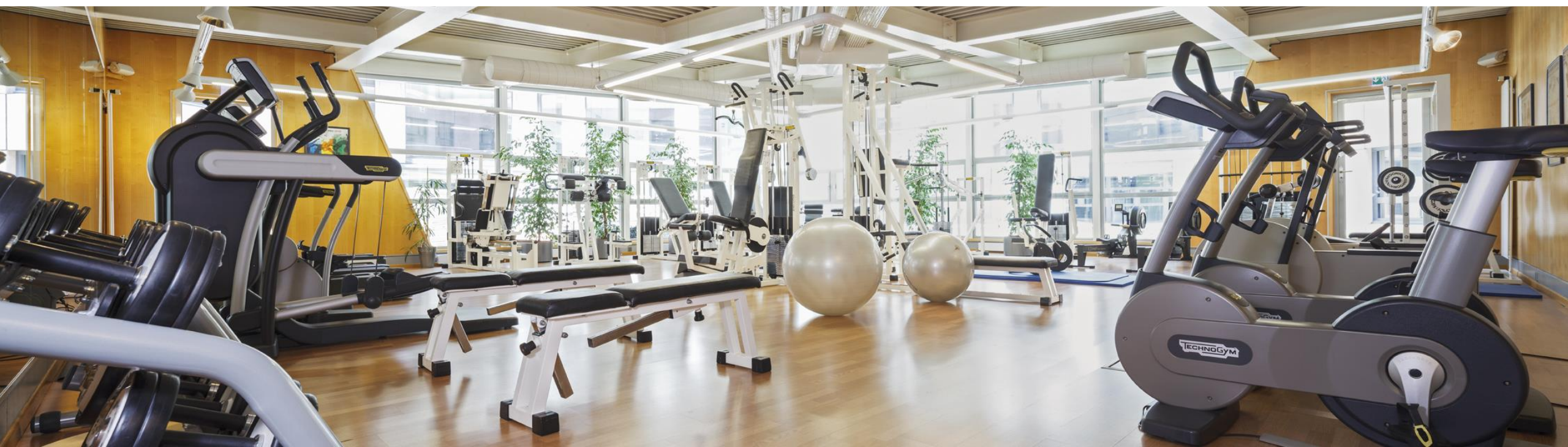



MÖVENPICK

CONTACT US

**Movenpick Hotels
Geneva & Lausanne**

Marina Riedy
Cluster Sales Manager

marina.riedy@movenpick.com
+41 79 847 14 18

Rooms Salles	Dimensions Surface sqm	Length Longueur	Width Largeur	Height Hauteur	Capacities in Persons Capacité de personnes	U-Shape Forme en U	Classroom Salle de cours	Boardroom Table de conférence	Theatre Théâtre	Banquet Banquet	Cocktail Cocktail	Cabaret Cabaret	Air Conditioning Climatisation	Daylight Lumière naturelle	Floor Etage
Olympia A	430	19	24.5	3	90	180	60	430	320	400	168	x	x	1	0
Olympia B	280	19	18	3	60	120	60	250	200	220	96	x	x	1	0
① Olympia 1	70	9	9.5	3	24	30	18	45	50	25	16	x	x	1	0
② Olympia 2	70	9	9.5	3	24	30	18	45	50	25	16	x	x	1	0
③ Olympia 3	70	9	9.5	3	24	30	18	45	50	25	16	x	x	1	0
④ Olympia 4	70	9	9.5	3	24	20	18	45	30	25	16	x	x	1	0
Olympia 1+2	152	19	9.5	3	39	70	42	120	80	100	56	x	x	1	0
Olympia 3+4	128	19	8.5	3	39	70	42	120	80	100	56	x	x	1	0
⑤ Olympia 5	33	6.6	5	3	15	18	12	25	18	20	12	x	x	1	0
⑥ Olympia 6	30	6	5	3	15	18	12	25	18	20	12	x	x	1	0
⑦ Olympia 7	26	5.2	5	3	9	18	12	25	18	20	12	x	x	1	0
Olympia 5+6	63	12.6	5	3	27	30	24	40	40	40	24	x	x	1	0
Olympia 6+7	57	11.2	5	3	27	36	24	40	40	40	24	x	x	1	0
Olympia 5+6+7	91	17.8	5	3	39	60	39	80	60	80	48	x	x	1	0
⑧ Zürich 1	31	6.5	4.8	3	9	12	12	20	10	15	10	x	x	0	0
⑨ Zürich 2	26	5.5	4.8	3	9	12	12	20	10	15	10	x	x	0	0
⑩ Zürich 3	35	7.3	4.8	3	15	18	18	30	20	25	12	x	x	0	0
Zürich 1+2	57	12	4.8	3	24	30	27	50	30	50	18	x	x	0	0
Zürich 2+3	61	12.8	4.8	3	24	30	27	50	30	50	18	x	x	0	0
Zürich 1+2+3	92	19.4	4.8	3	42	60	45	80	60	80	32	x	x	0	0
I	30	7.3	3.9	2.5	12	14	14	25	—	20	—	x	x	1	1
II	37	7	5.25	2.5	—	—	12	15	—	—	—	x	x	1	1
III	20	5.15	3.7	2.5	—	12	12	15	—	—	—	x	x	1	1
IV	20	5.15	3.7	2.5	—	12	12	15	—	—	—	x	x	1	1
III+IV	40	7.2	5.15	2.5	16	28	14	35	—	25	—	x	x	1	1
V	26	7	5.25	2.5	10	8	10	15	—	—	—	x	x	1	1
VI	51	7.2	3.9	2.5	18	24	14	35	—	—	—	x	x	1	1
VII	16	3.9	3.5	2.5	—	—	8	15	—	—	—	x	x	1	1
VIII	16	3.9	3.5	2.5	—	—	8	15	—	—	—	x	x	1	1
VII+VIII	30	7.2	3.9	2.5	16	16	14	25	—	20	—	x	x	1	1

Meetings Events

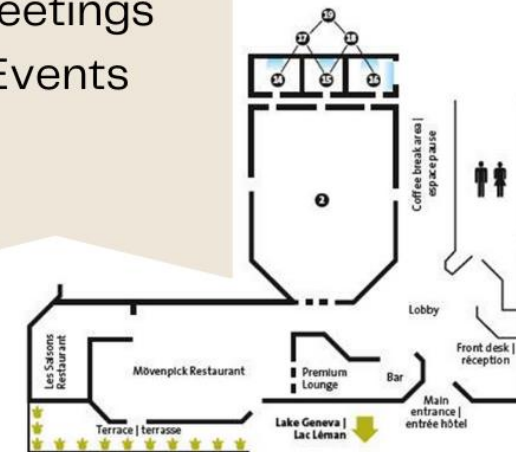

Olympia/variations

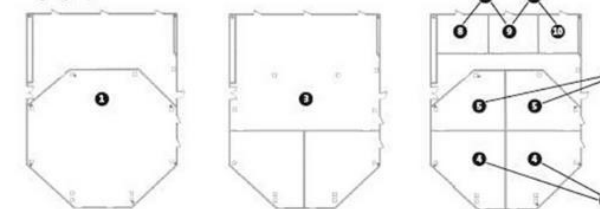

1st floor | 1^{er} étage

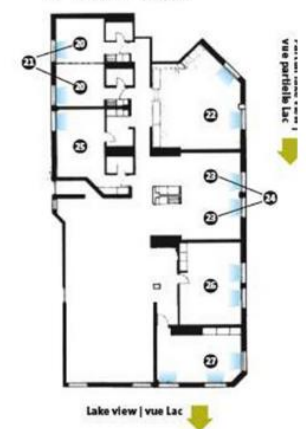

Daylight | Lumière naturelle

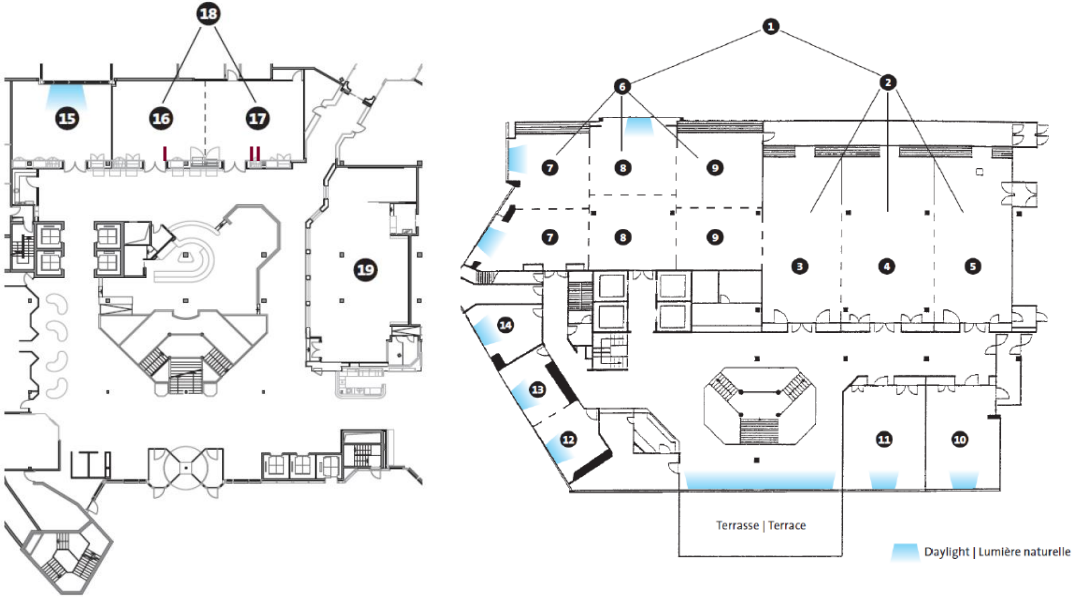

Rooms Salles	Dimensions				Capacities in persons Capacité de personnes	U-Shape Forme en U	Classroom Salle de cours	Boardroom Table de conférence	Theatre Théâtre	Banquet Banquet	Cocktail Cocktail	Cabaret Cabaret	Air-Conditioning Climatisation	Daylight Lumière naturelle	Floor Etage
	Surface m²	Length Longueur	Width Largeur	Height Hauteur											
① Lindbergh/Blériot	610	42.25	14.5	2.7	-	-	-	-	-	400	800	-	x	x	1
② Lindbergh	322	21.25	15	2.7	55	180	65	320	200	360	125	-	x	-	1
③ Dassault	102	15	6.75	2.7	36	60	40	110	80	140	35	-	x	-	1
④ Garros	124	15	8.25	2.7	36	60	50	130	90	150	35	-	x	-	1
⑤ St. Exupéry	102	15	6.75	2.7	36	60	40	100	70	120	35	-	x	-	1
⑥ Blériot	286	21	13	2.7	45	160	50	220	200	280	115	-	x	-	1
⑦ Dornier	90	13	7	2.7	24	30	30	70	60	120	35	-	x	x	1
⑧ Douglas	104	13	7	2.7	30	60	35	100	80	130	35	-	x	x	1
⑨ Morane	90	13	7	2.7	30	45	30	90	60	120	35	-	x	-	1
⑩ Lilienthal	54	9	6	2.7	15	28	18	35	30	50	24	-	x	x	1
⑪ Zeppelin	65	9	7.5	2.7	21	30	18	40	40	50	24	-	x	x	1
⑫ Boeing I	17	5	3.5	2.7	-	-	8	-	-	-	-	-	x	x	1
⑬ Boeing II	16	4	3.5	2.7	-	-	8	-	-	-	-	-	x	x	1
⑭ Airbus	20.36	5.8	3.5	2.7	-	-	8	-	-	-	-	-	x	x	1
⑮ Apollo	71	9.5	7.5	2.7	24	30	24	60	-	80	35	-	x	x	0
⑯ Arienne I	69	8.8	7.8	2.7	24	30	24	60	-	80	35	-	x	-	0
⑰ Arienne II	74	9.5	7.8	2.7	24	30	24	60	-	80	35	-	x	-	0
⑱ Arienne	143.5	18.4	7.8	2.7	48	60	55	140	100	150	75	-	x	-	0
⑲ Belle-Epoque	149	15.7	9.5	2.85	-	-	-	-	-	80	180	-	x	-	0
⑳ Montgolfier	45.5	10.7	4.25	2.7	-	-	16	-	-	-	-	-	x	x	14

Green Globe and Level 3 Swisstainable certified for both properties



Environment

We minimize damage to the environment, as energy consumption and contamination. Human Resources

Human Resources

We do not consider religion nor culture as a criterion. Health and accident prevention are a priority

Water Efficiency

Since 2016, all sinks in the rooms have flow-limiting aerators. And since 2017, all bathrooms have been equipped with energy-efficient shower heads. The water consumption per customer decreased by 24% between 2015 and 2022

Waste Management

"Zero Plastic Use" program set up in 2022. "Too Good to Go" program to avoid food waste.

